



INVESTICE DO ROZVOJE VZDĚLÁVÁNÍ

Postup sestavení robota: Robopes



Krok 1

STEP 1

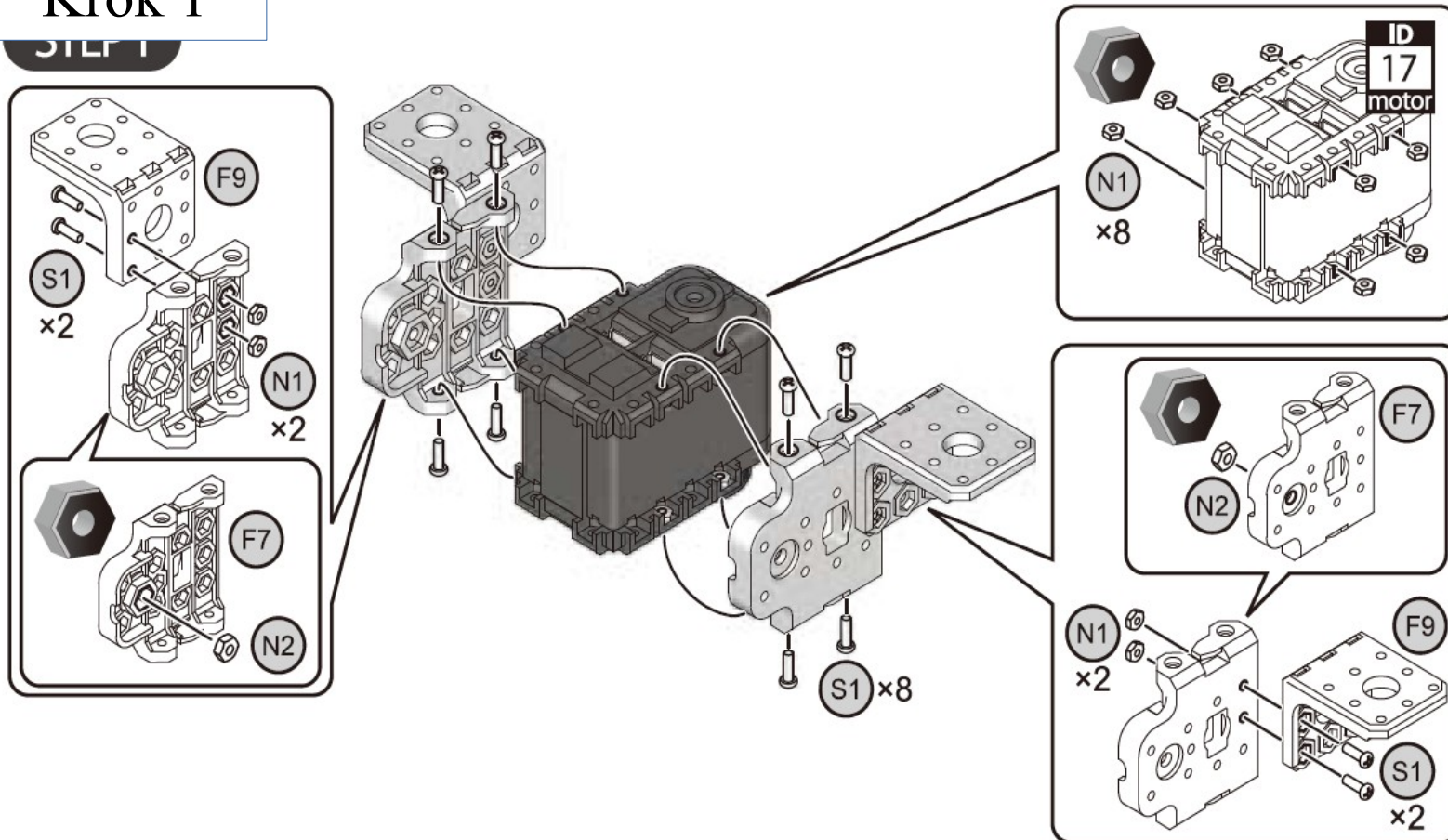

Krok 2

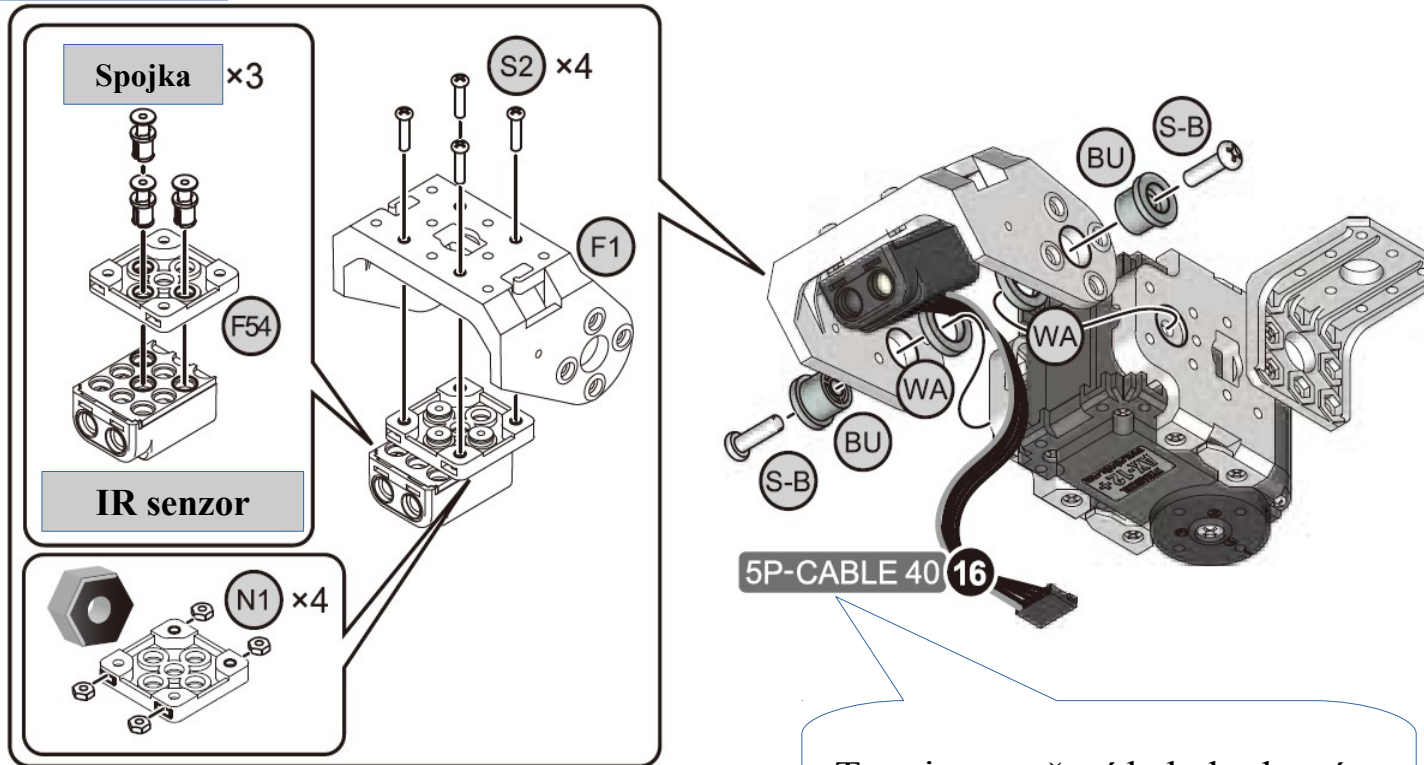

Toto je označení kabelu, kterým lze připojit IR senzor.

Krok 3

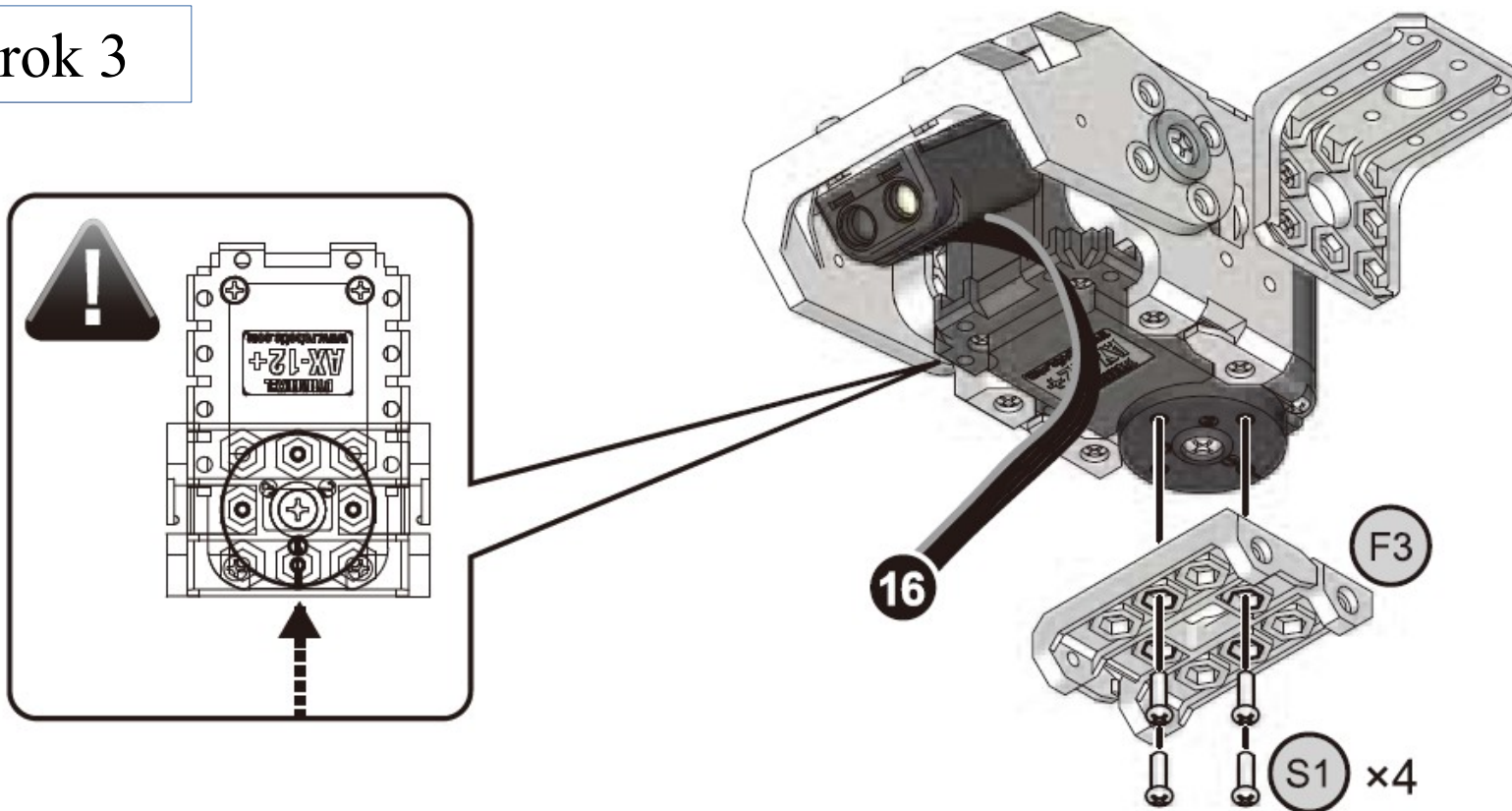

Krok 4

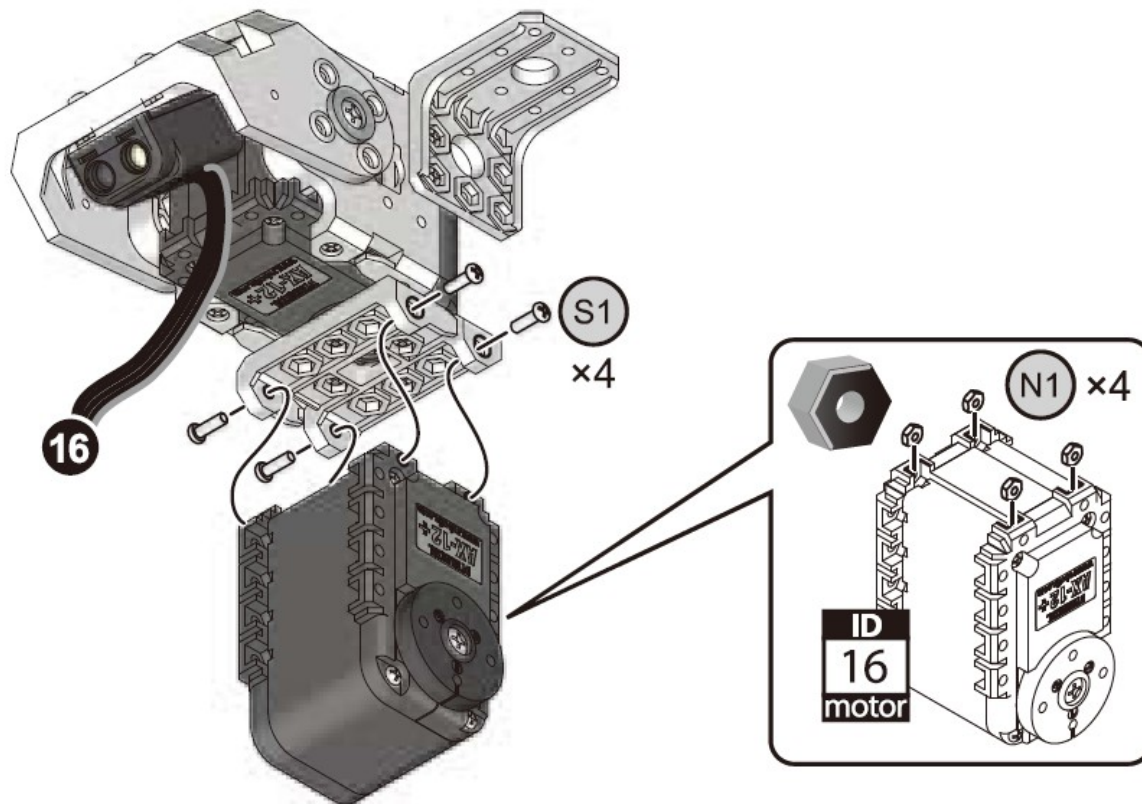
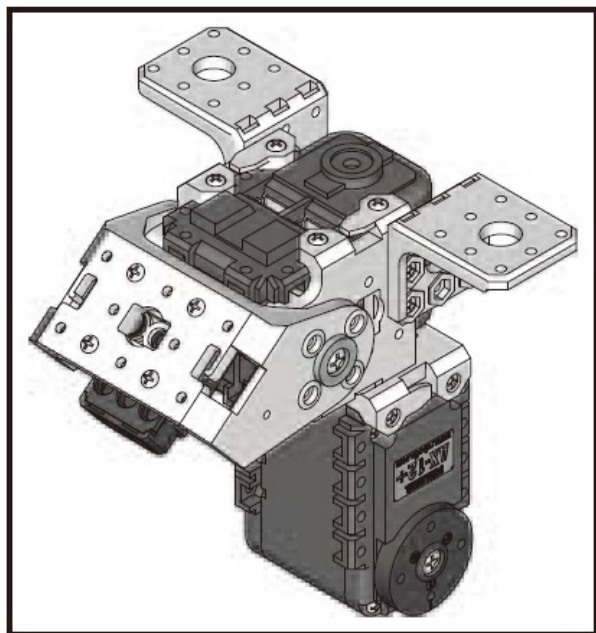

Krok 5

ID 5

STEP 6

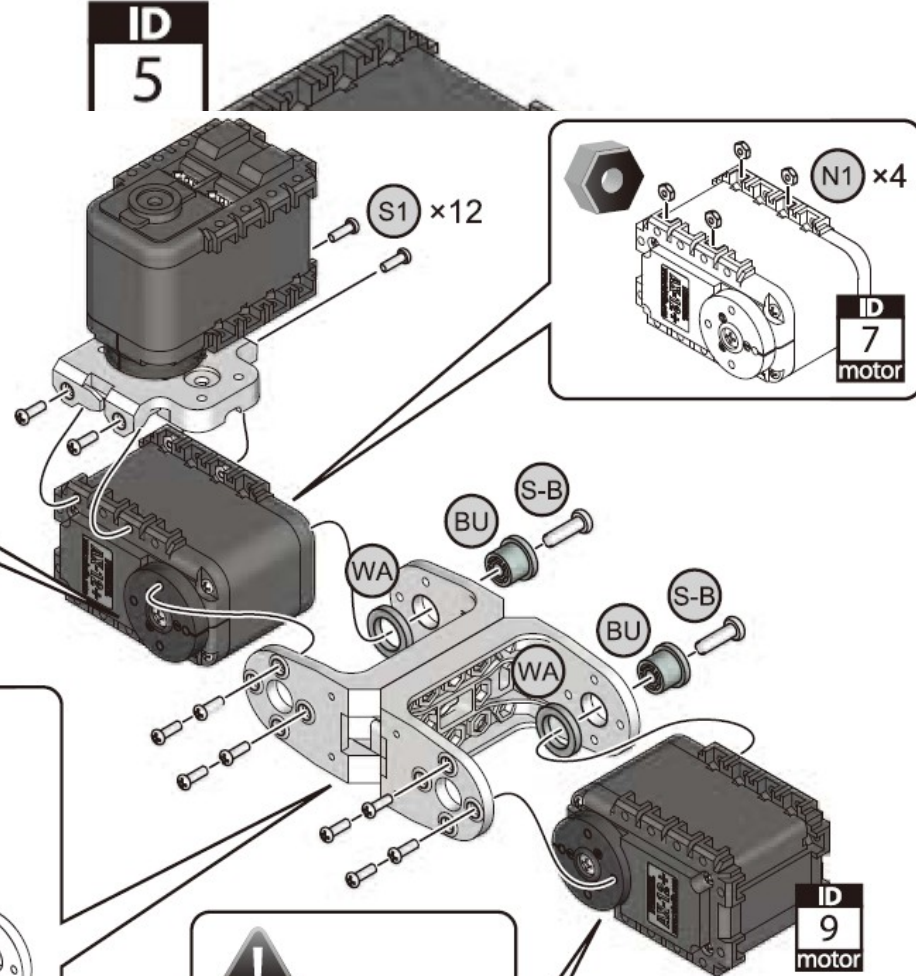
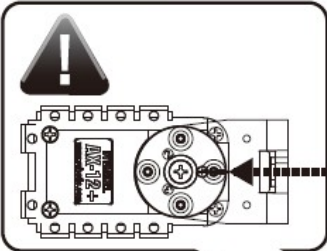
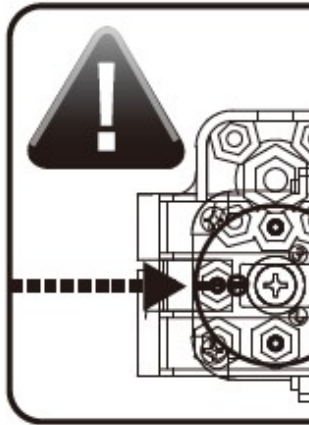

4

Krok 6

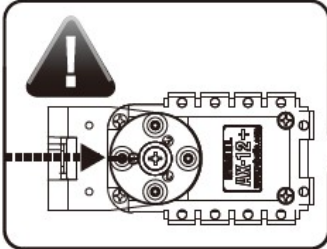
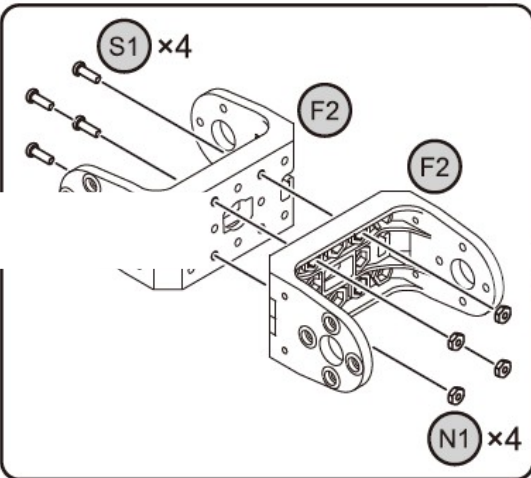

STEP 7

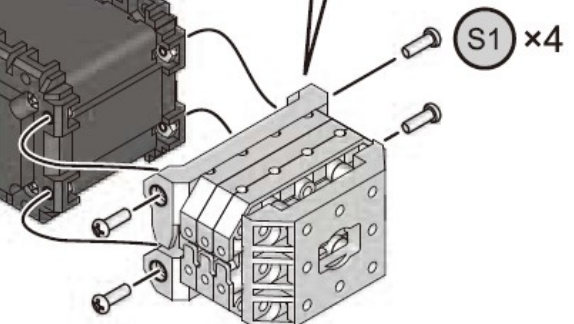
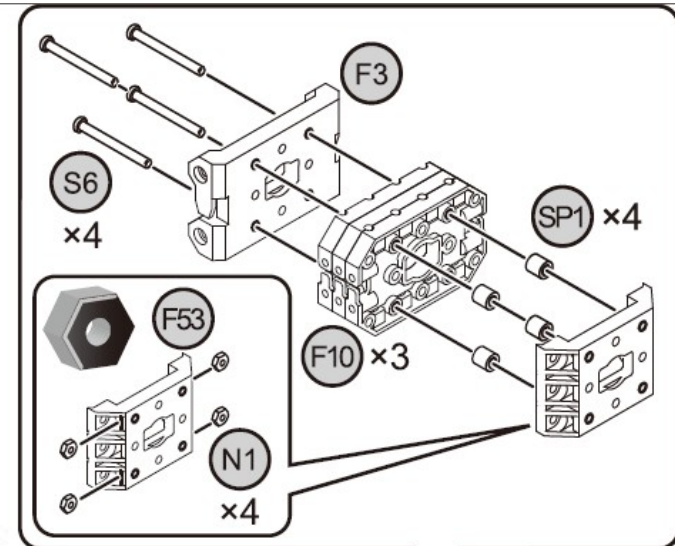
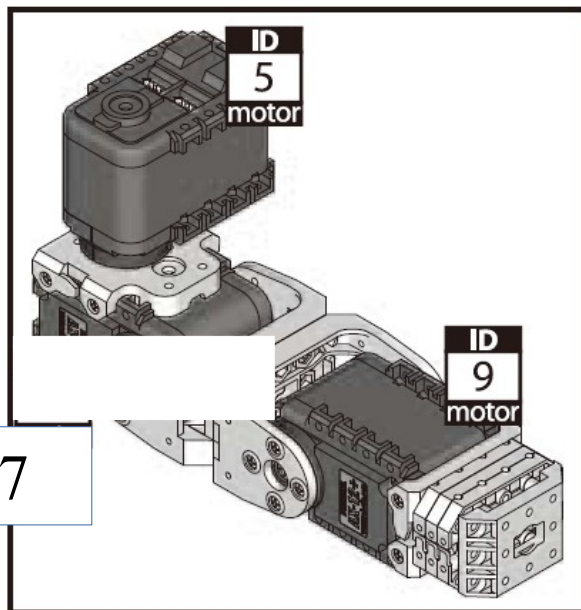
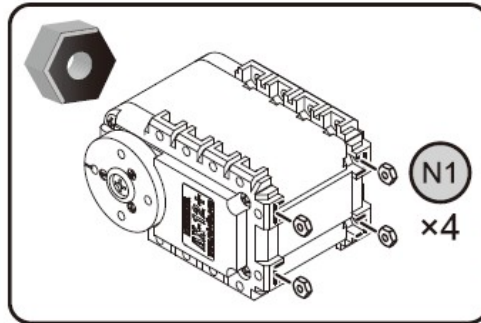

Krok 7

Krok 8

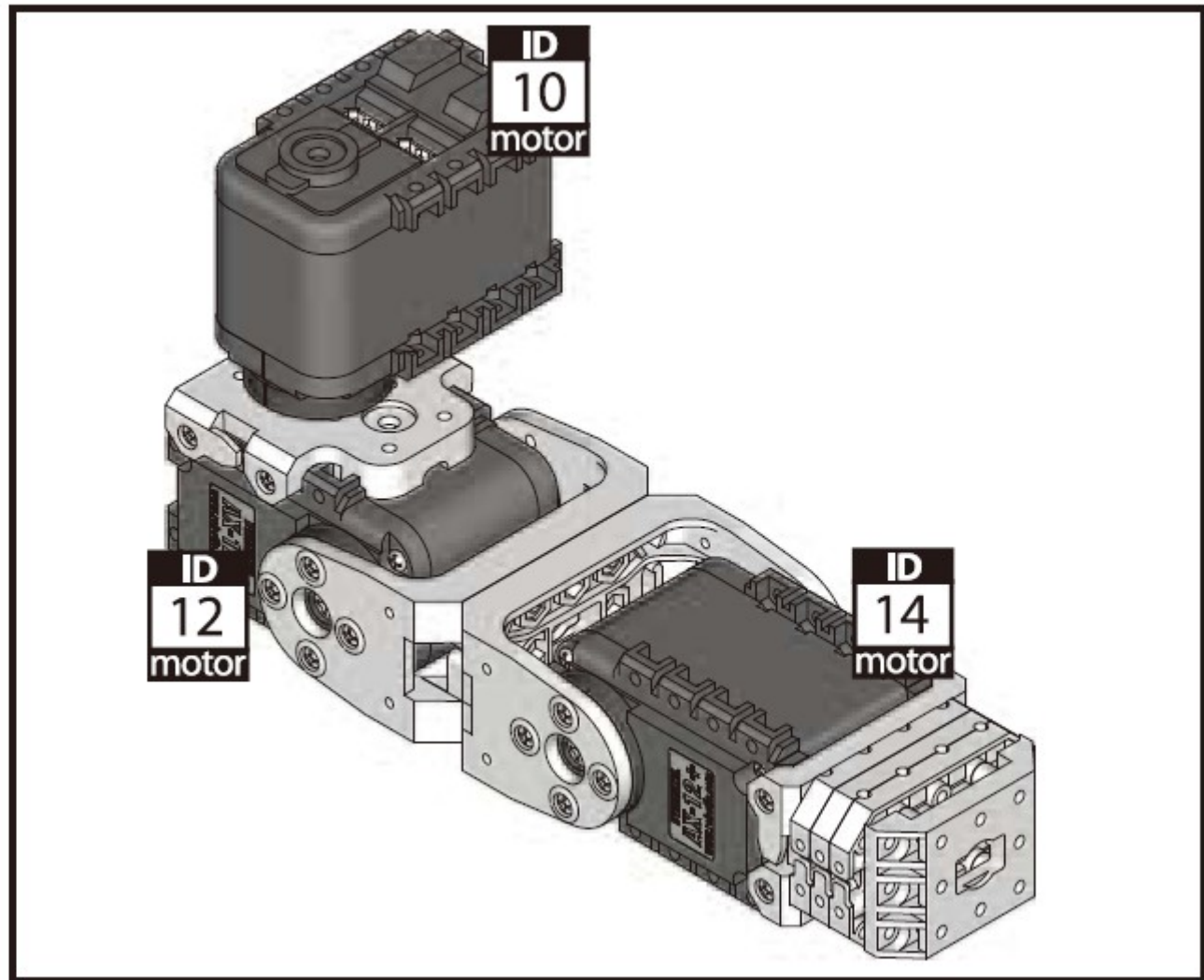

Krok 9

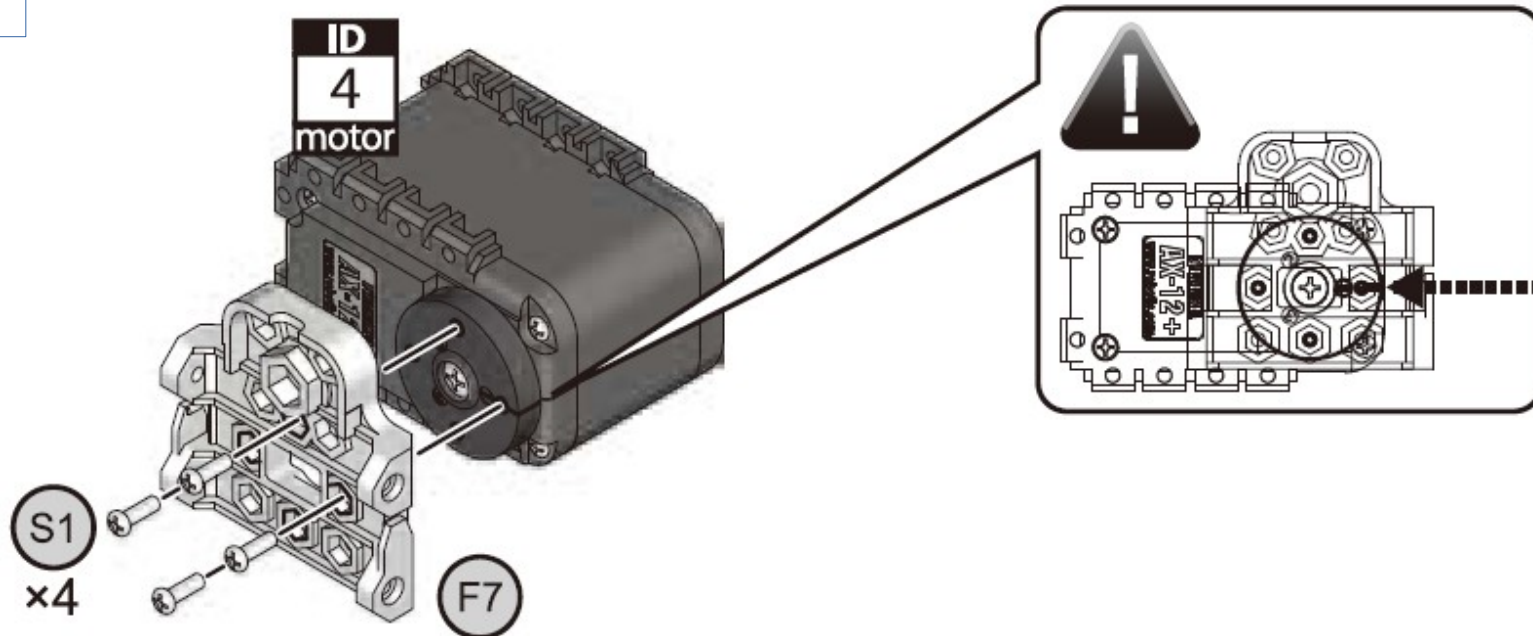

Krok 10

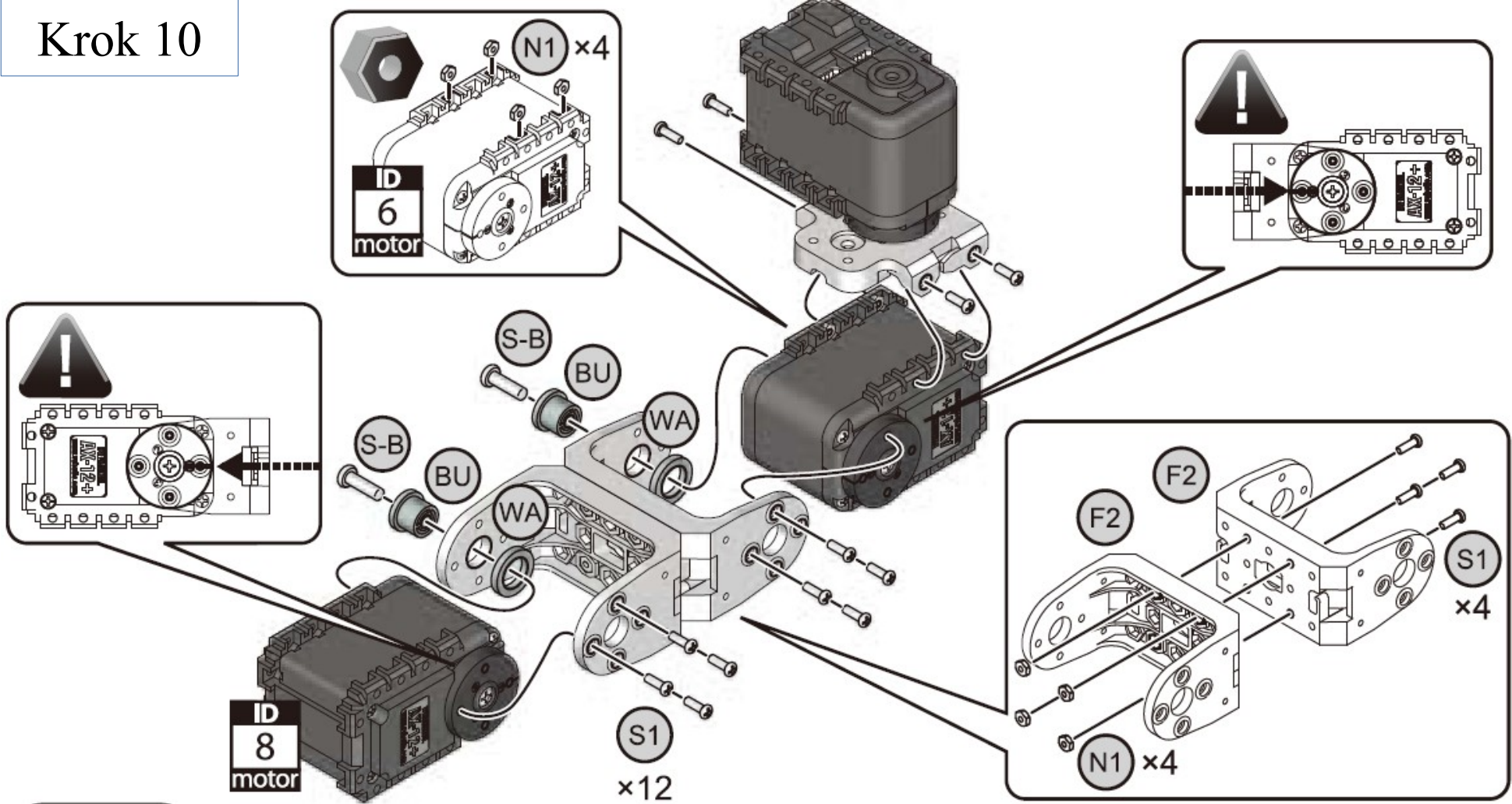

Krok 11

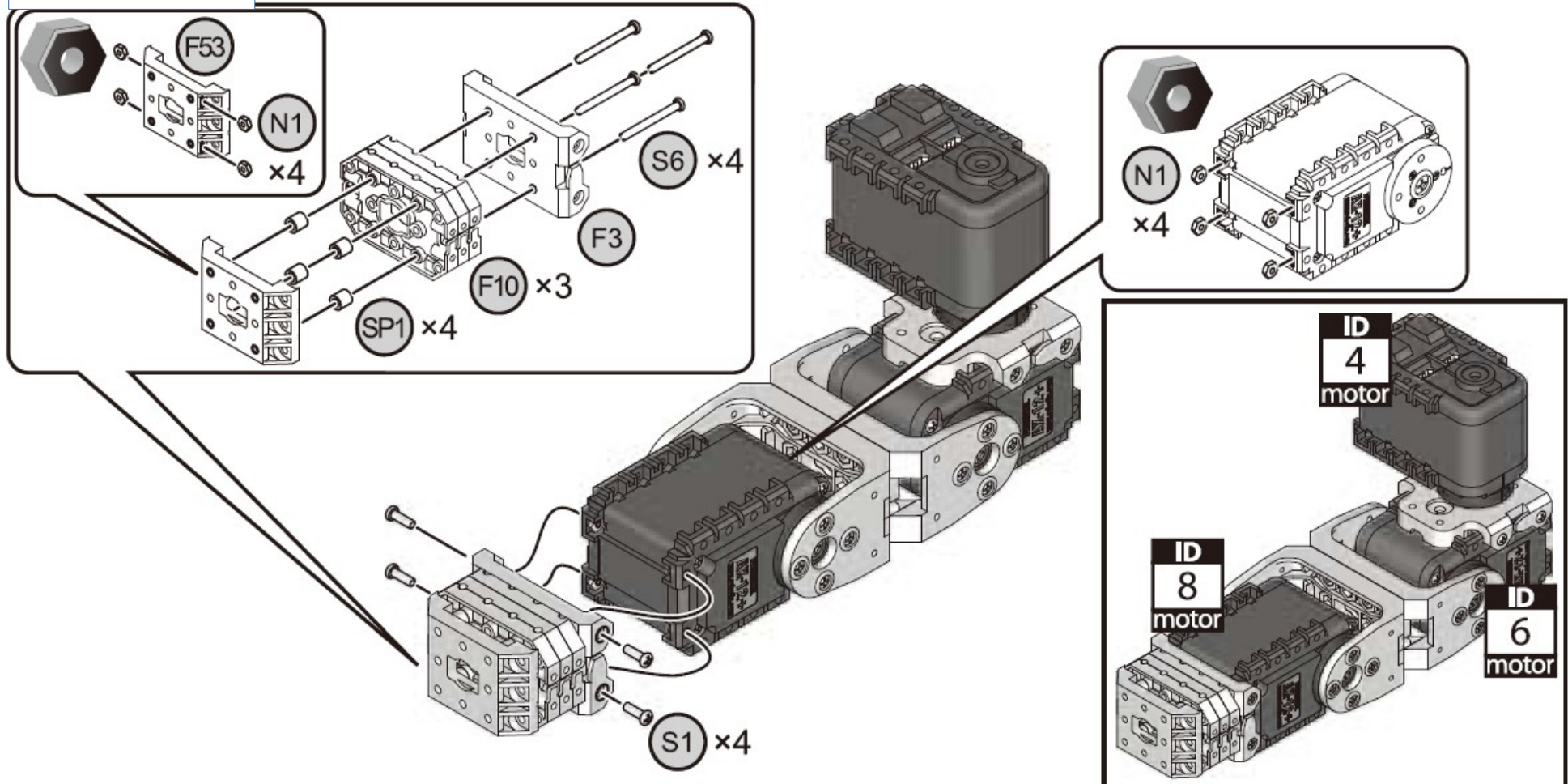

Krok 12

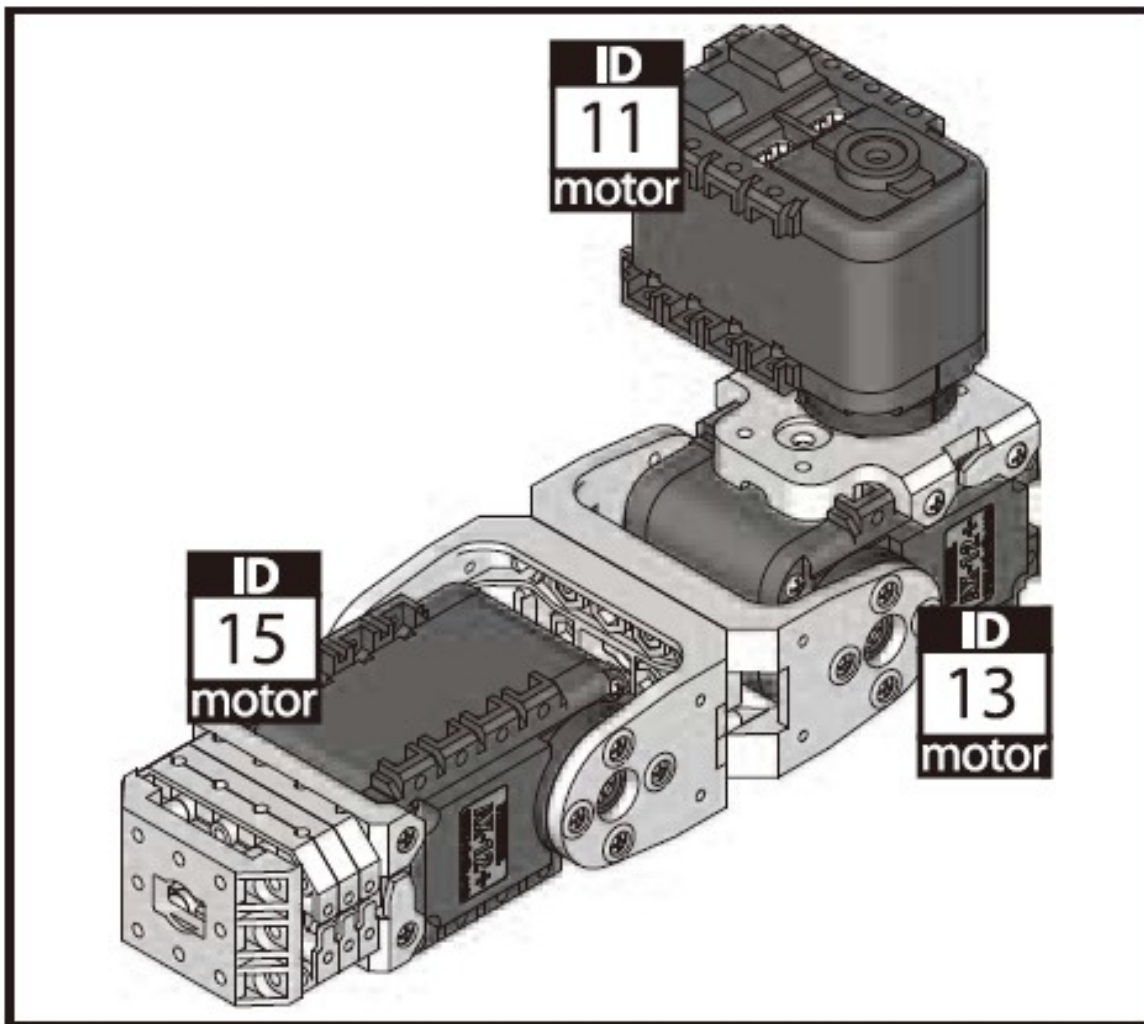

Krok 13

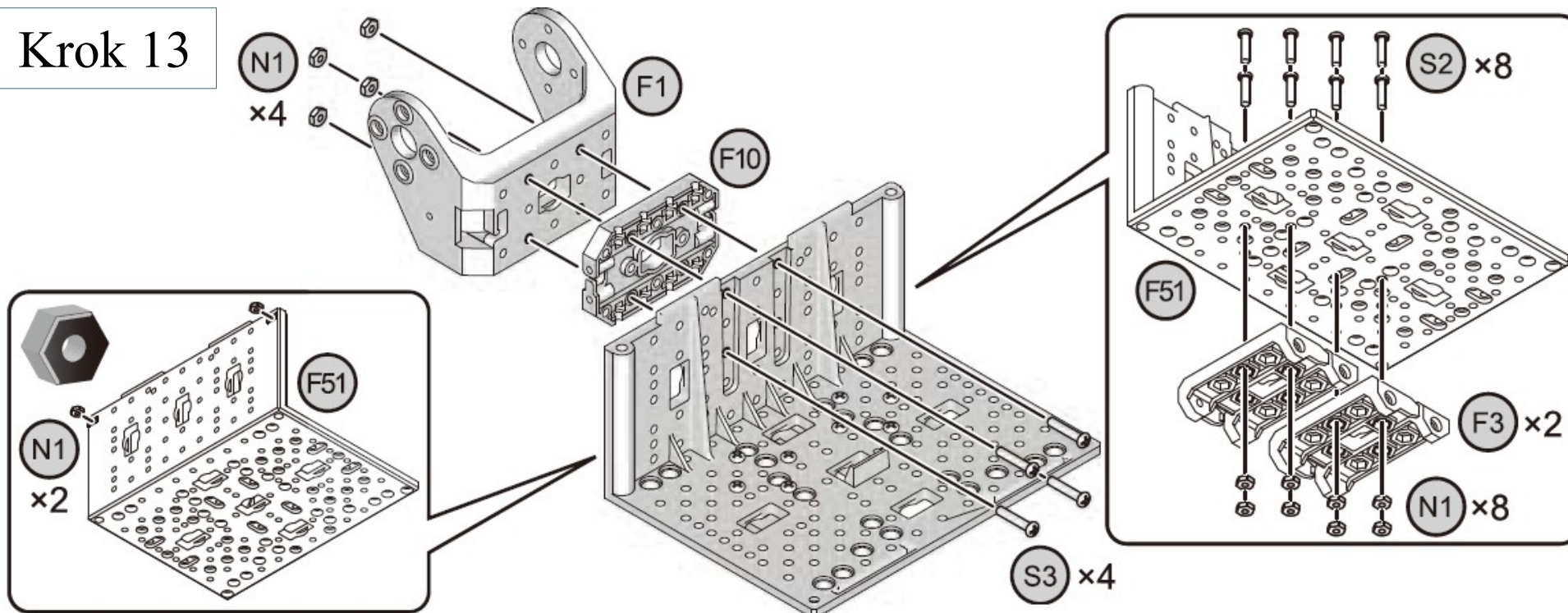

Krok 14

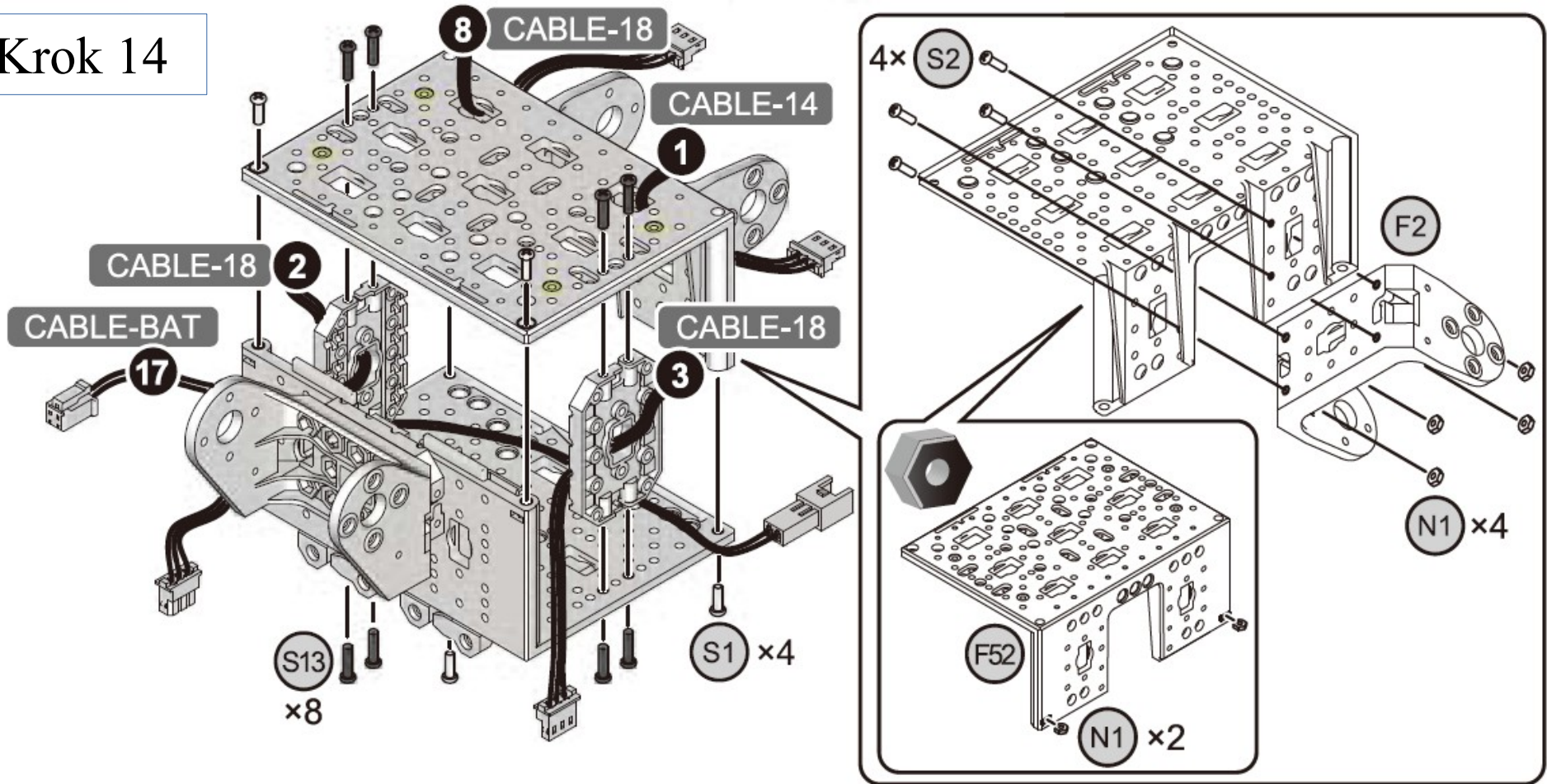

Krok 15

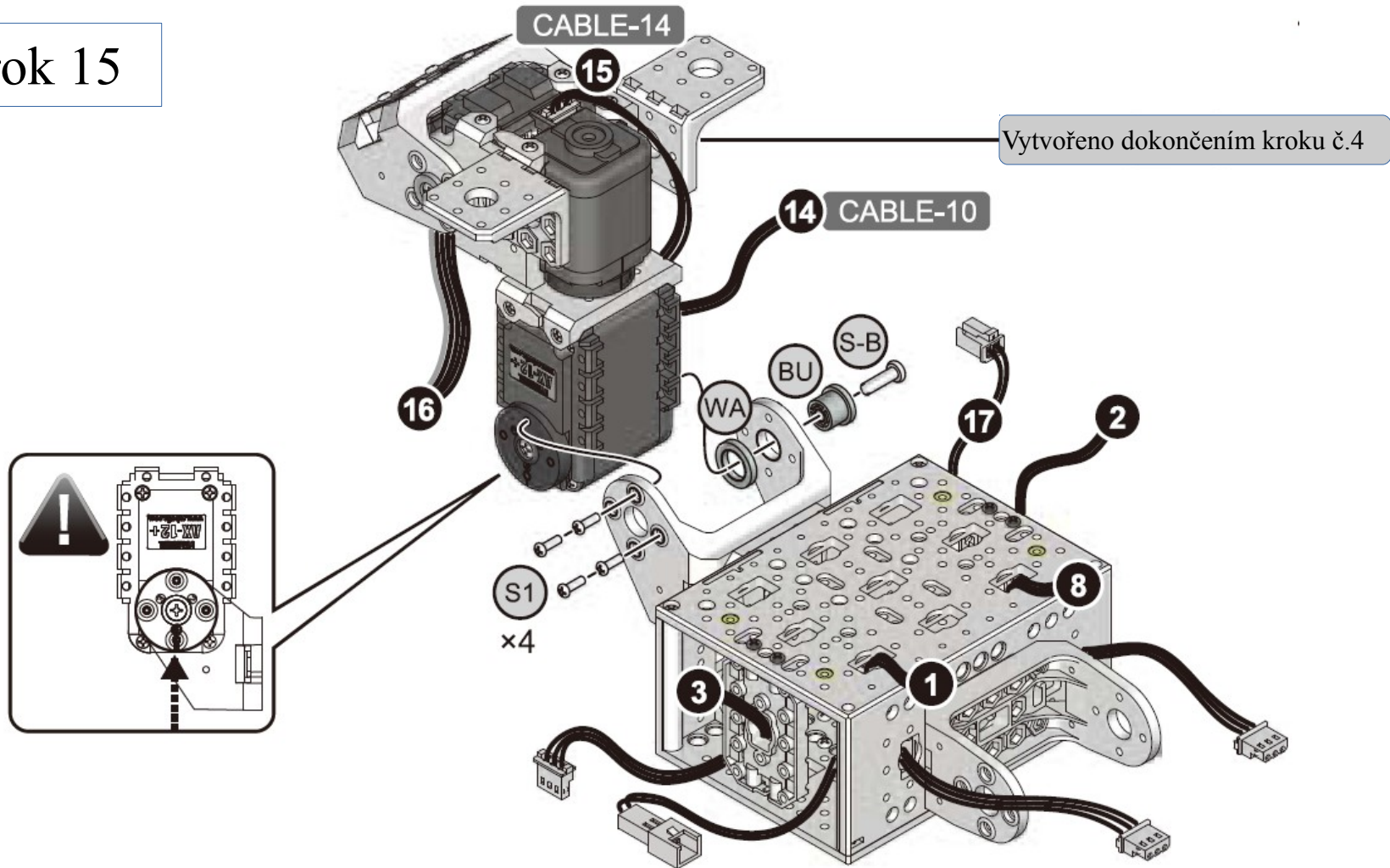

Krok 16

Detail A

Vytvořeno dokončením kroku č.7

Vytvořeno dokončením kroku č.11

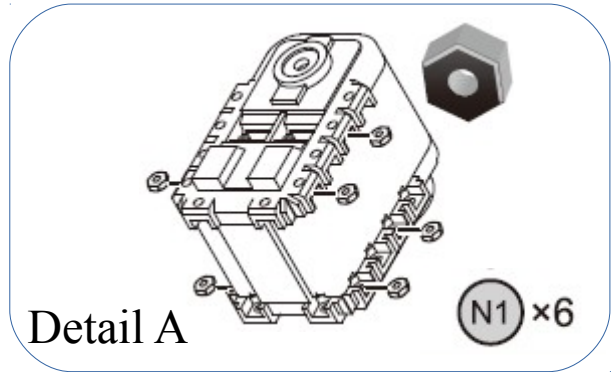
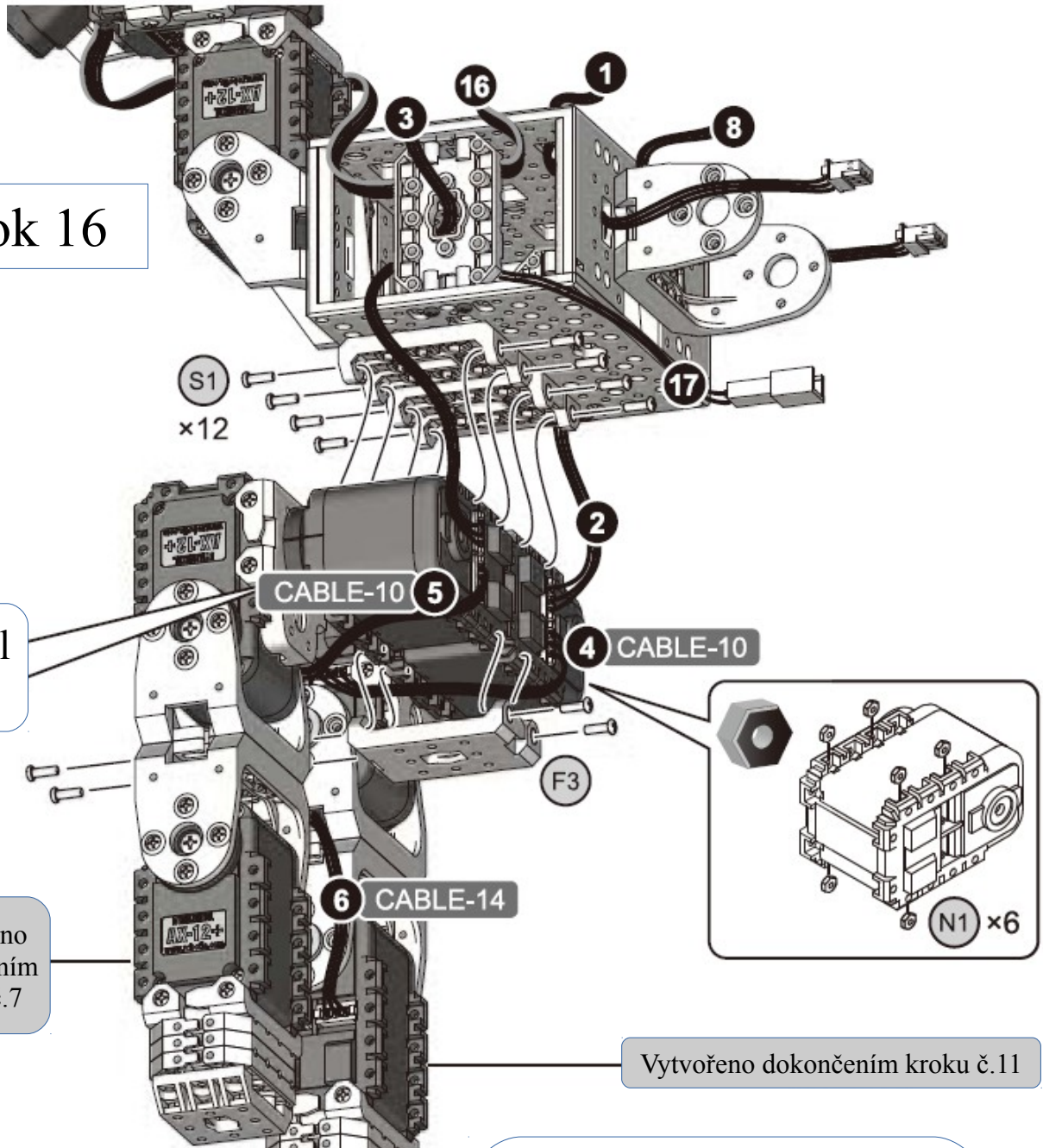

Krok 17

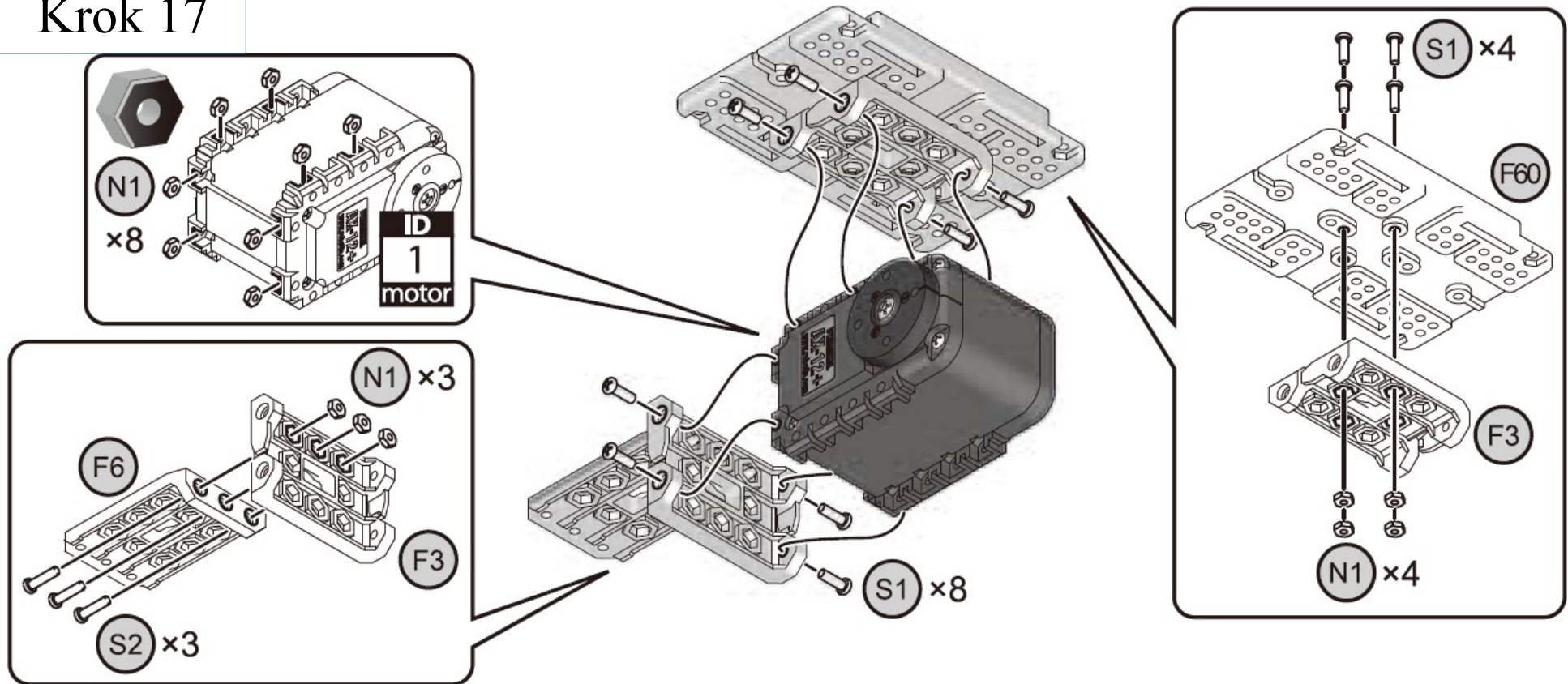

Krok 18

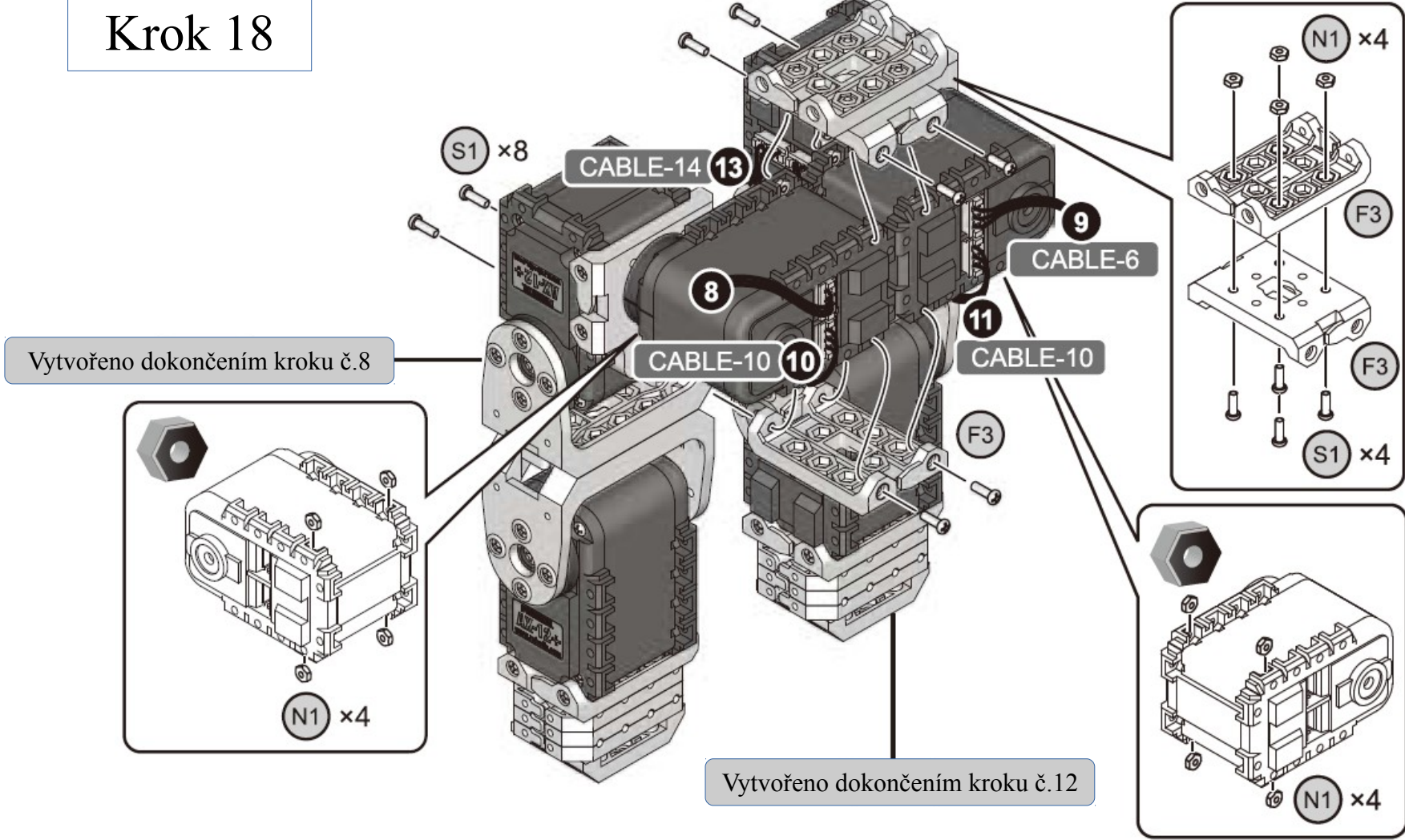

Krok 19

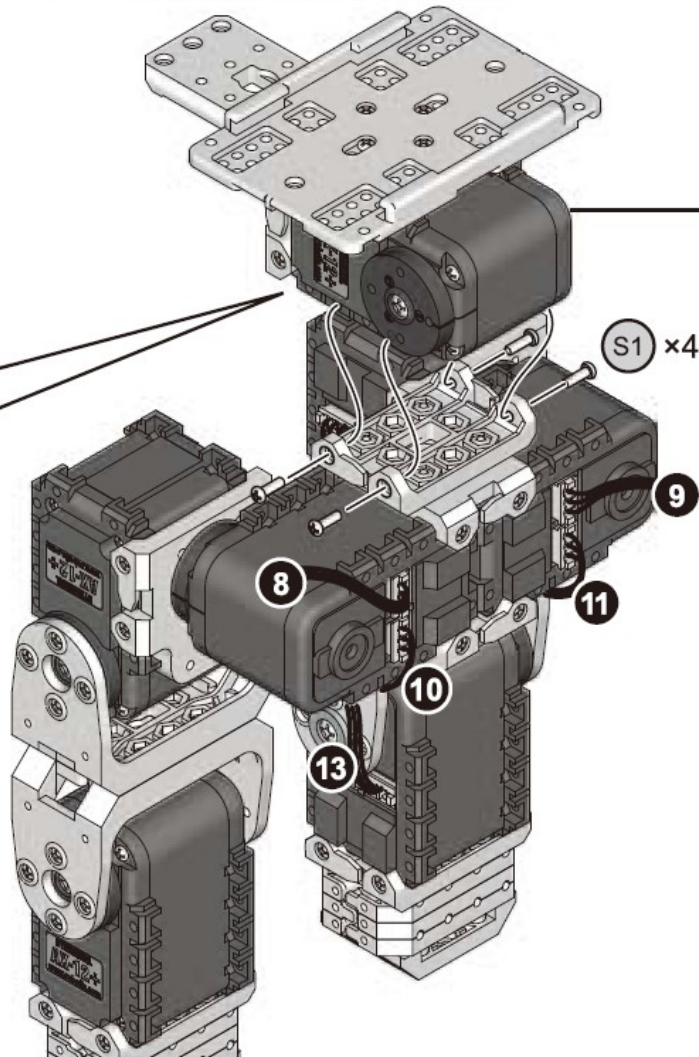
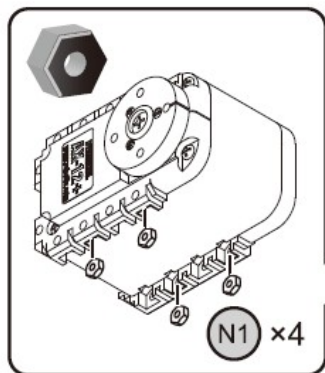

Vytvořeno dokončením kroku č.17

Krok 20

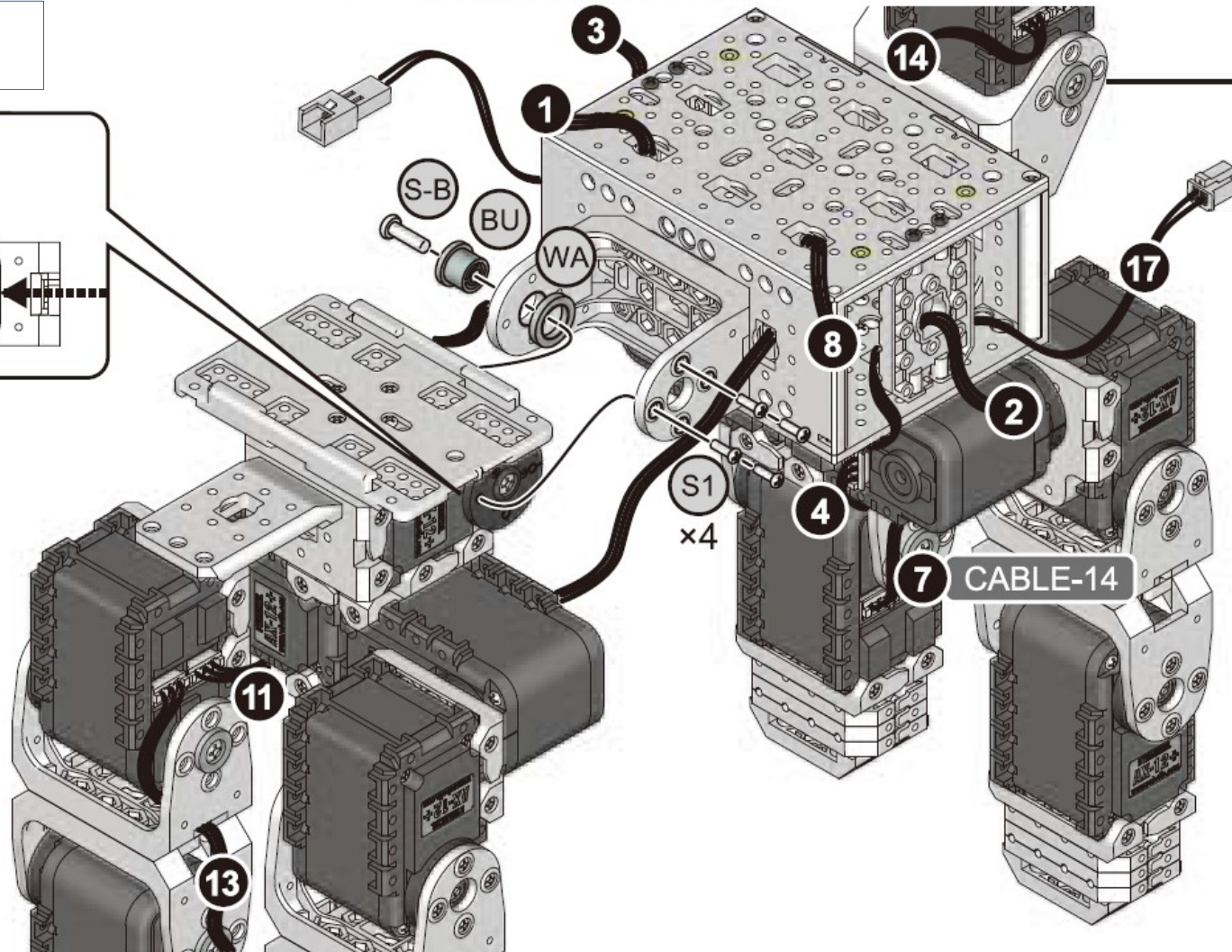
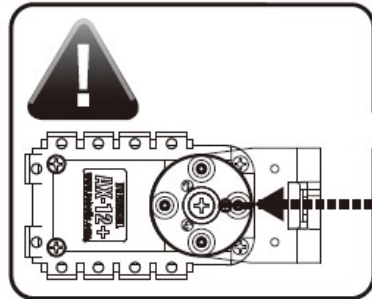

STEP 18

Krok 21

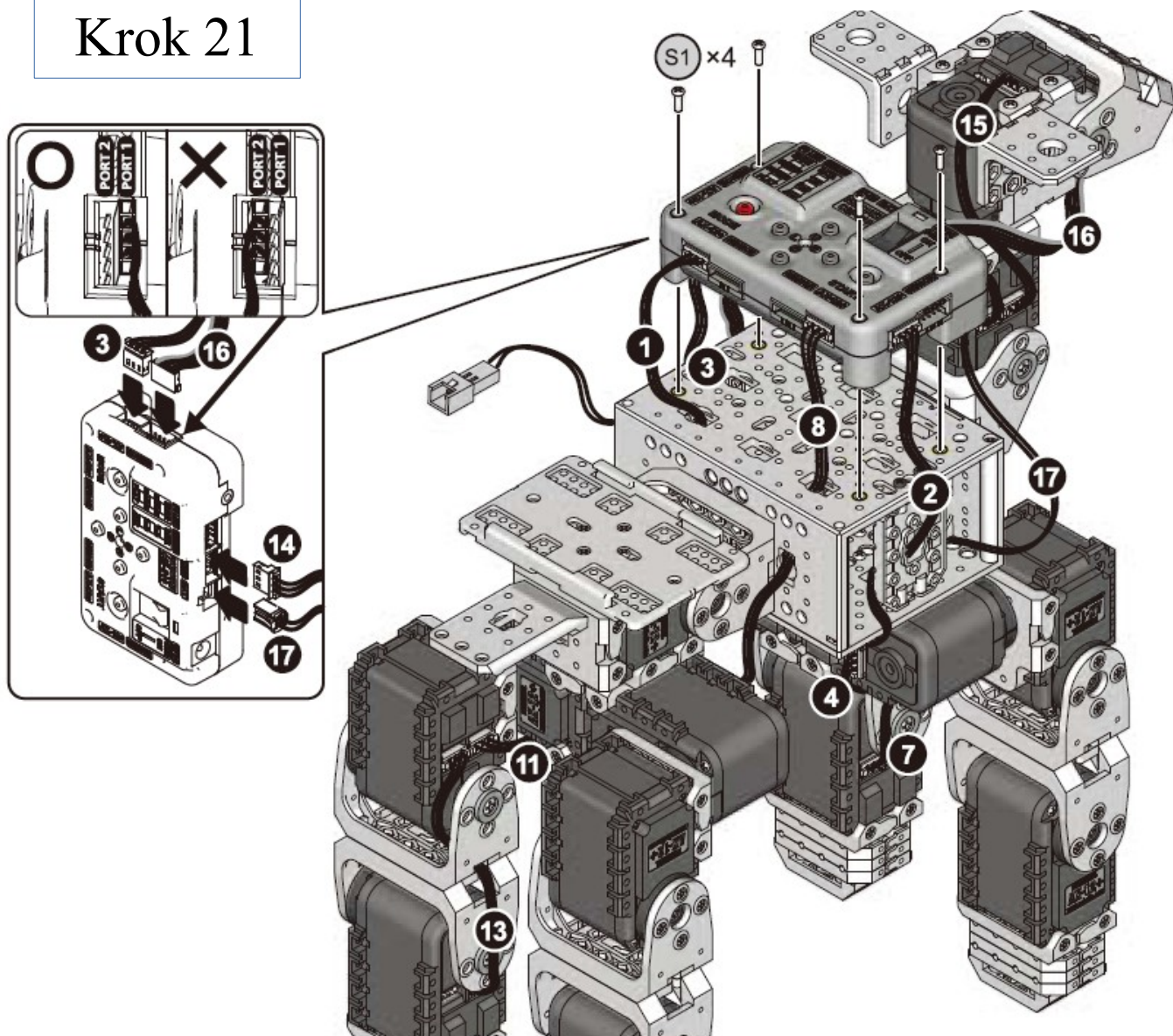

Krok 22 – propojení pohonů

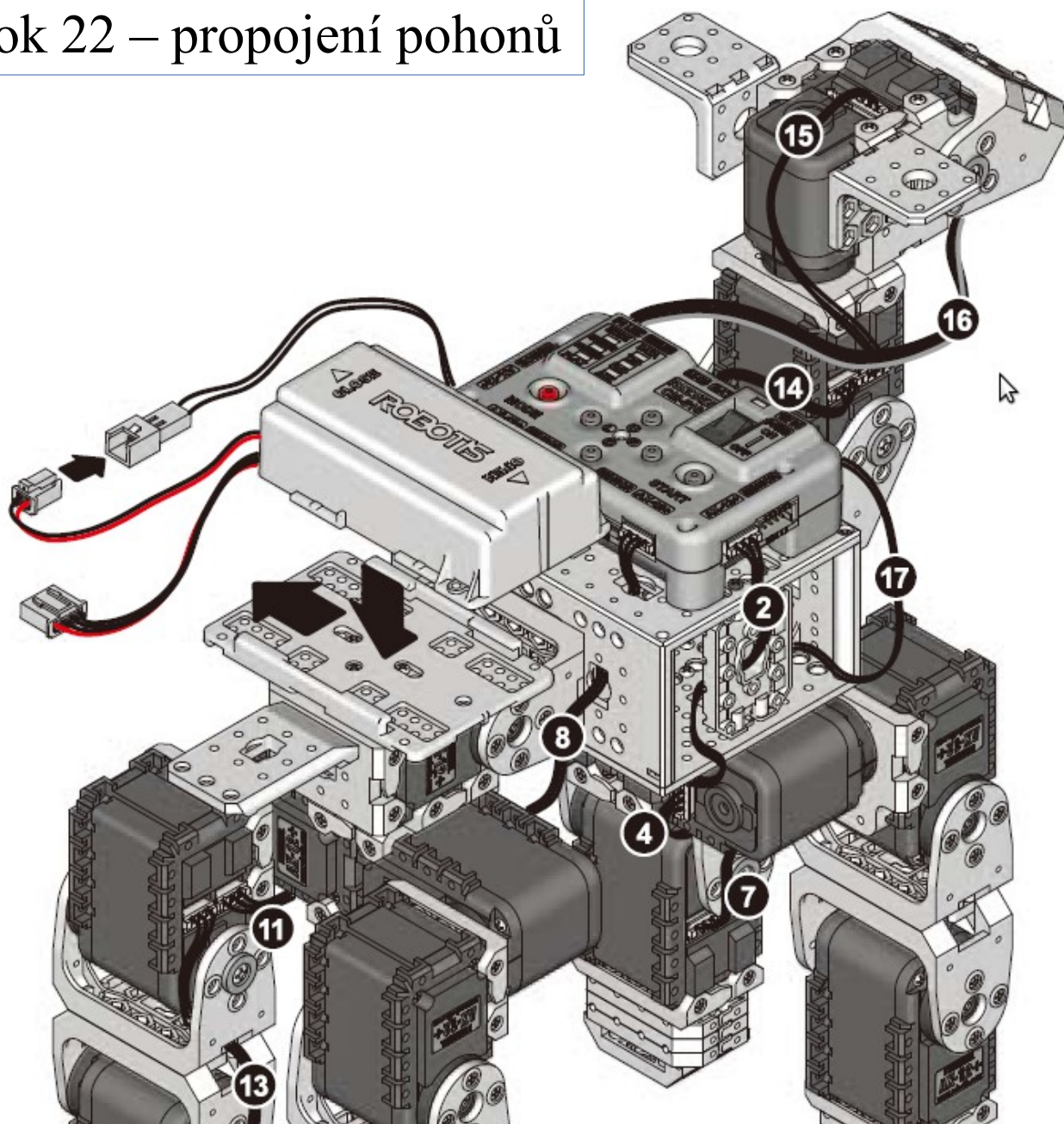

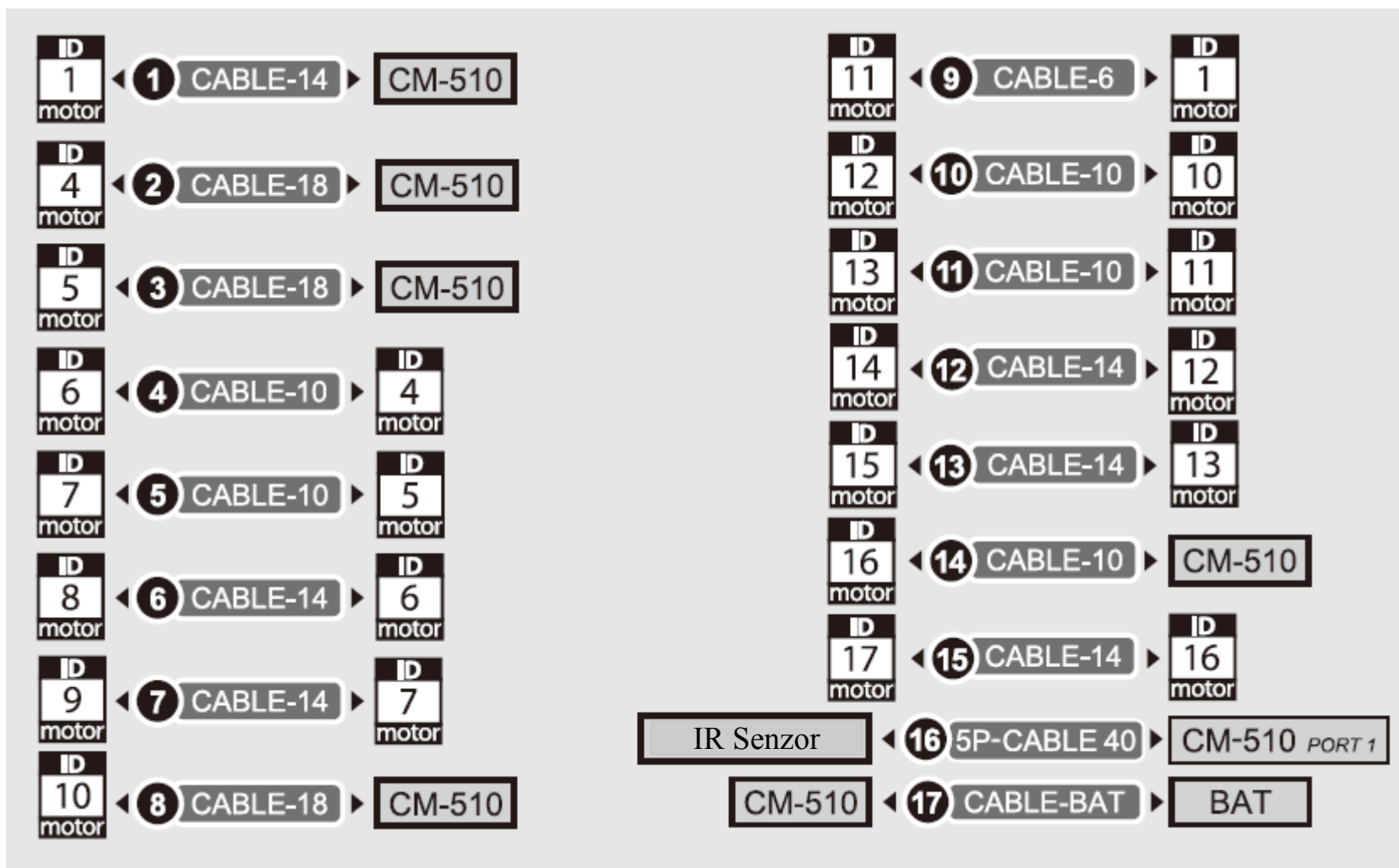

Kontrola identifikátorů

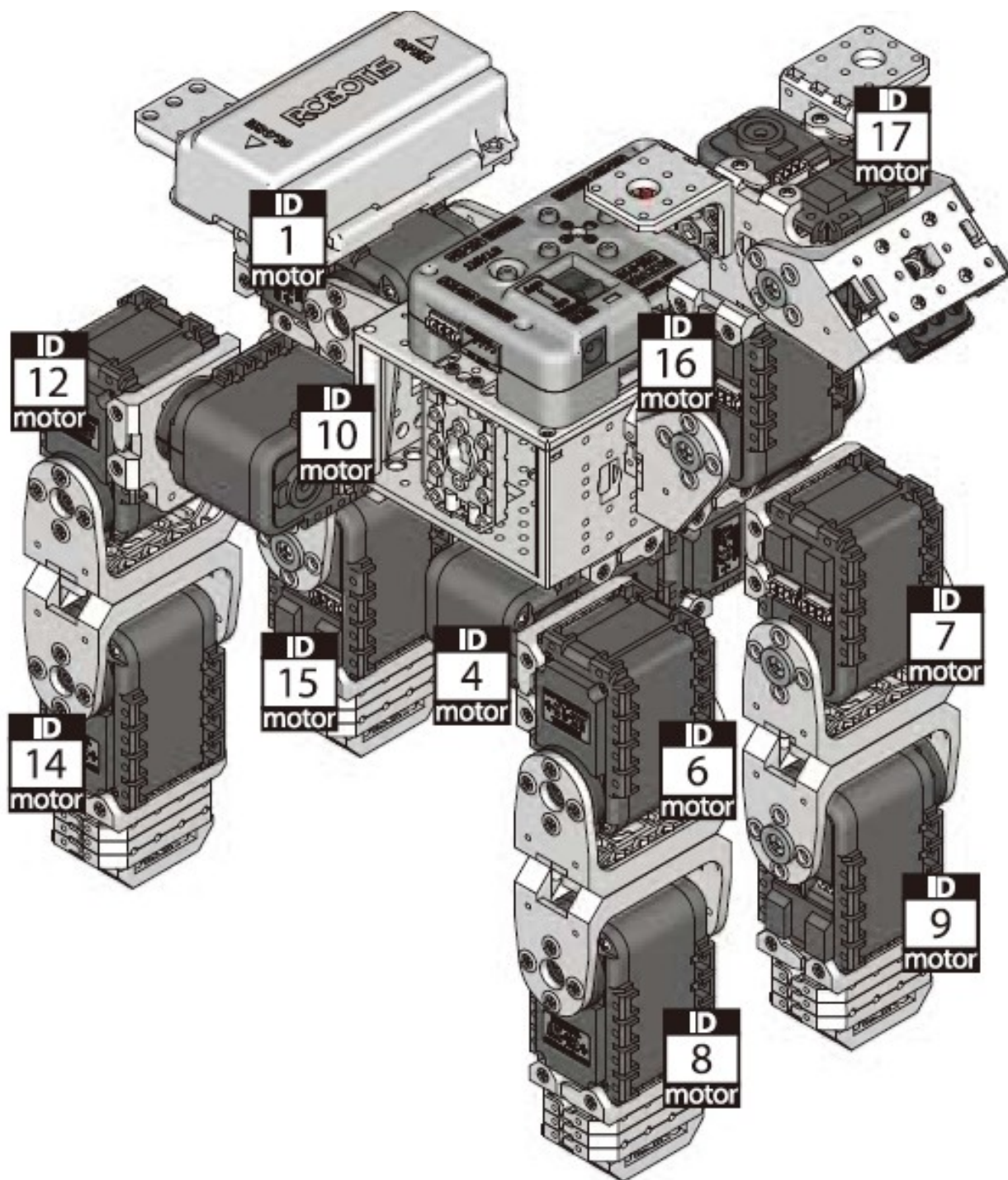

Kontrola identifikátorů

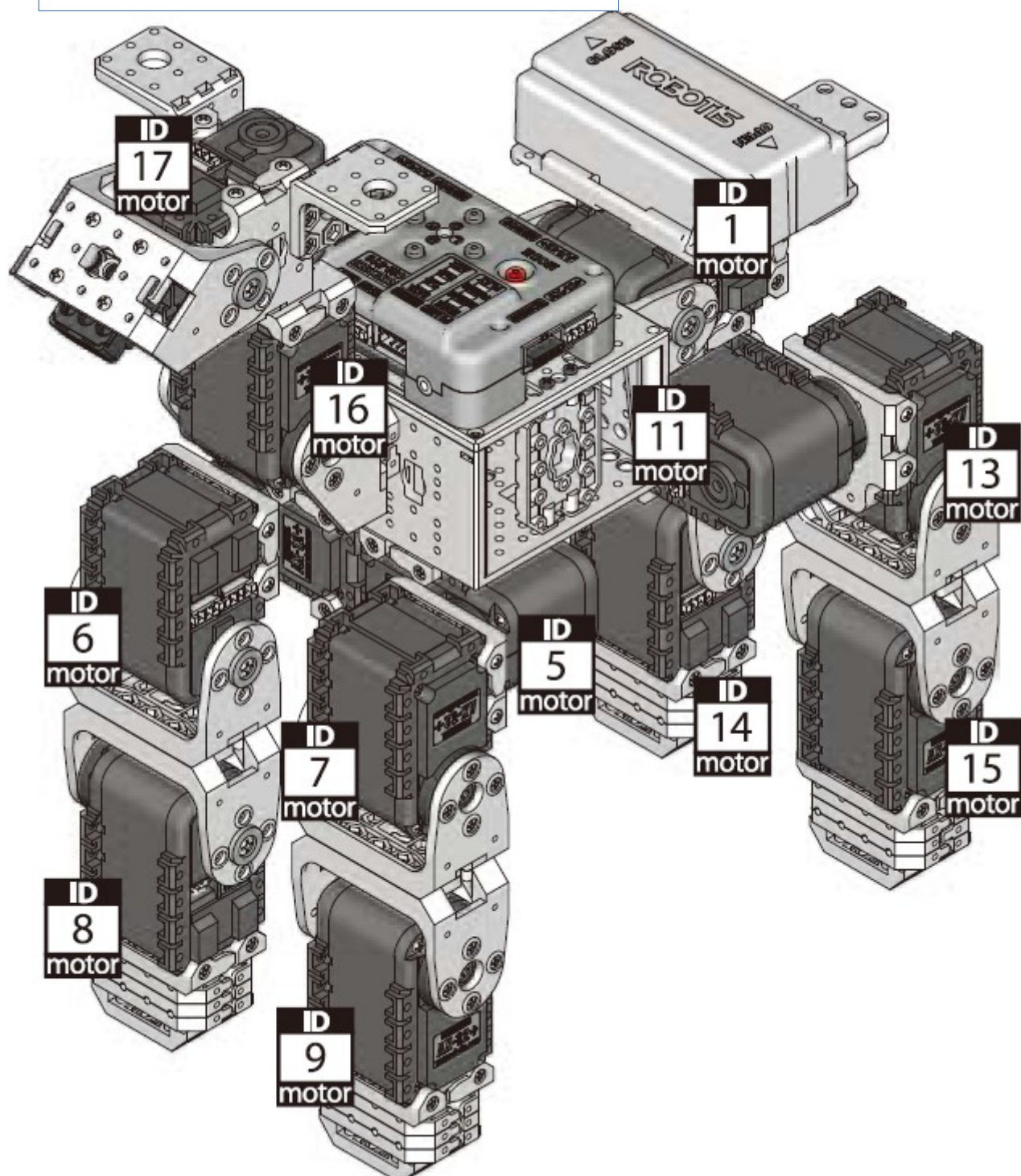

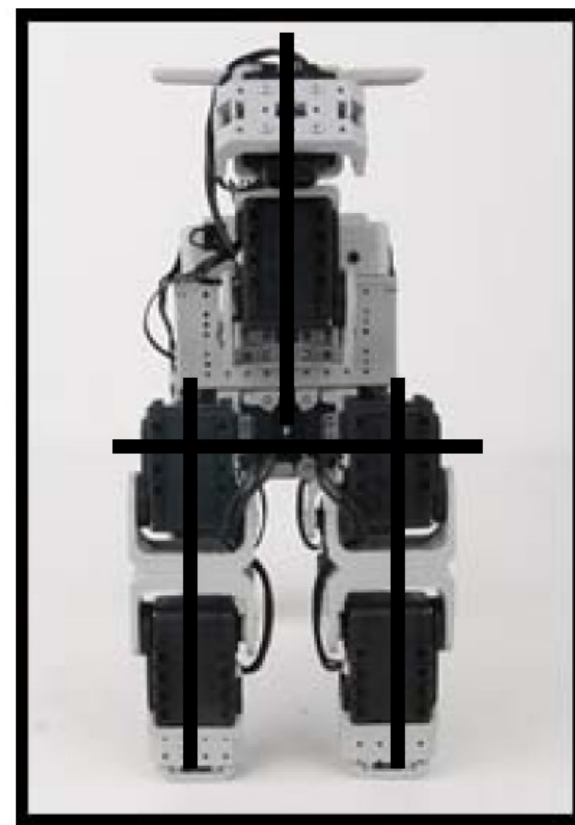
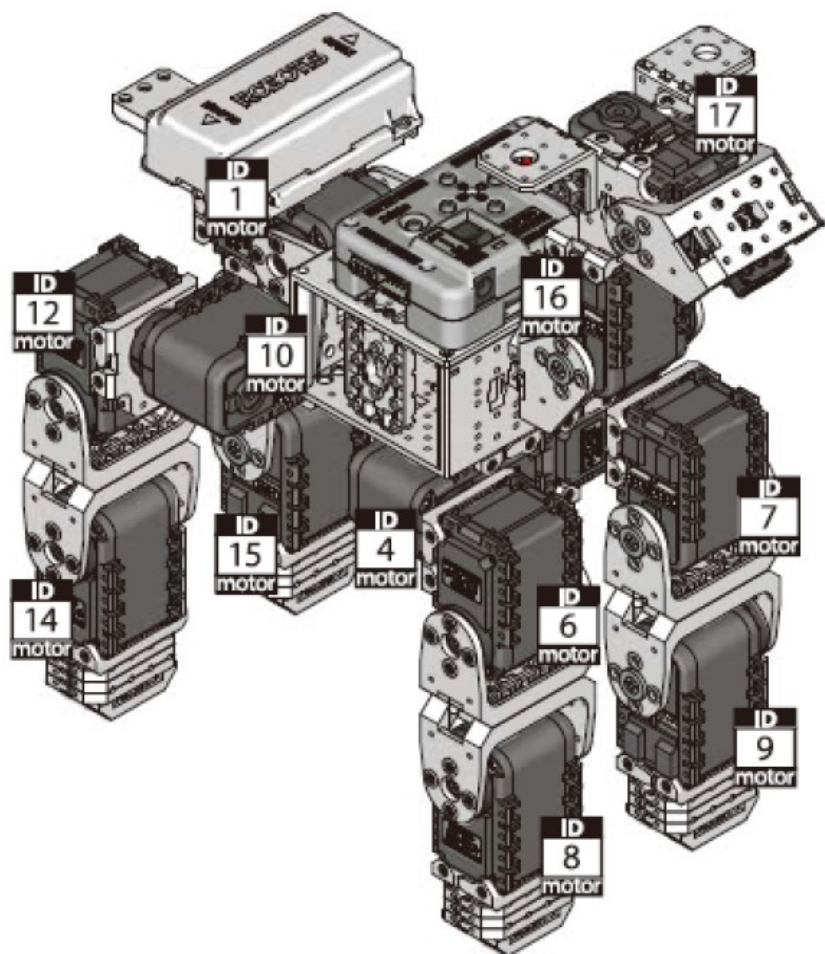

INVESTICE DO ROZVOJE VZDĚLÁVÁNÍ

